

Handles

Handles

For horizontal or vertical attachment to the enclosure panel of:

- Comfort Panel
- Optipanel
- Other enclosures or
- Surfaces

Mounting holes and surfaces without fins are required for assembly purposes.

For the Comfort Panel version with fins, selectable via configurators at www.rittal.com, corresponding milling work may be carried out. To this end, please specify "Prepared for handle set 6107.XXX" for the command panel.

Material:

- Handle holder: Die-cast zinc
- Cover bungs: Plastic
- Handle tube: Aluminium

Surface finish:

- Handle tube: Powder-coated

Colour:

- Handle holder: RAL 7035
- Cover bungs: Similar to RAL 7035
- Handle tube: Similar to RAL 9006

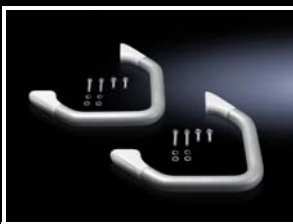

Corner handle

Supply includes:

- 4 handle holders
- 2 handle tubes
- Assembly parts

Mounting on enclosure corner

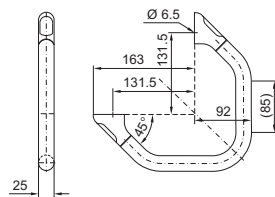

Packs of	Model No.
1 set(s)	6107.000

Mounting on straight surfaces
(90° rotation of handle holder)

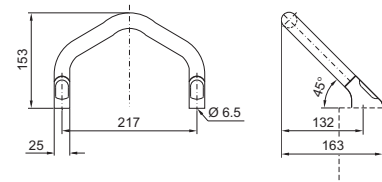

U handle

Supply includes:

- 2 handle holders
- 1 handle tube
- Assembly parts

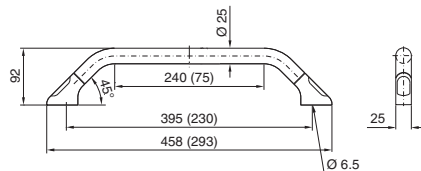
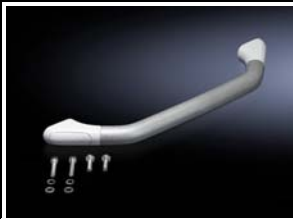

Note:

- Dimensions in brackets for front size 7 U

For front panel size	Packs of	Model No.
≥ 7 U	1 set(s)	6107.100
482.6 mm (19")	1 set(s)	6107.200



Accessories:

- For 6107.200: Clipboard, see page 703
- For 6107.200: Display board, see page 703