

# Hygienic Design production data cabinet



## Material:

- Stainless steel 1.4301 (AISI 304)
- Enclosure: 1.5 mm  
Door: 2.0 mm
- Lock inserts: Stainless steel
- Seal: Silicone, compliant with FDA Guideline 21 CFR 177.2600

## Surface finish:

- Brushed, grain 400,  $R_A < 0.8 \mu\text{m}$
- Seal: Blue, dyed (RAL 5010)

## Protection category IP to DIN 40 050-9:

- Enclosure top: IP 59K
- Enclosure bottom: IP 69K

## Console supply includes:

- Roof angled forwards by 30°
- Door with integrated polycarbonate pane for monitor; compartment with screw-fastened mounting plate with holes for VESA connection 75 and 100
- Viewing window 535 x 325 mm
- Mounting plate height-adjustable for monitors up to 24"

## Pedestal supply includes:

- Roof angled forwards by 3°, suitable as a support rest or for keyboard installation
- Component shelf spray-finished, pull-out and height-adjustable with side punched rails

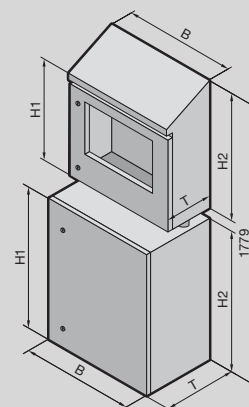

## HD production data cabinet, modular

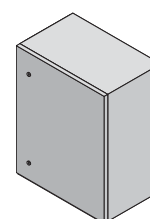
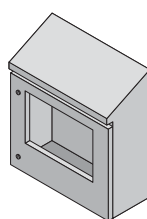

	Packs of	Console	Pedestal
<b>Width (B)</b> mm		810	810
<b>Height (front) (H1)</b> mm		692	863
<b>Height (rear) (H2)</b> mm		848	888
<b>Depth (T)</b> mm		266	496
<b>Model No.</b>	1 pc(s).	<b>4000.062</b>	<b>4000.064</b>

## Accessories

T handles with/without lock cylinder		on request
HD levelling feet		see Cat. 34, page 172
HD connection components		see page 14
Other accessories		see page 14

## Other optional modifications:

- Enclosure top: without viewing window, with mounting panel instead of mounting plate
- Enclosure top: with cut-out for touch panel instead of viewing window
- Enclosure bottom: without side rails, without component shelf, with mounting panel
- Both enclosures with drilled holes for connection components