

# Roof/Wall Mounting

## Wall mounting

### Slotted wallmount bracket

for KL, EB, JB, AE, WM

This bracket has similar functionality to a standard NEMA flange plate, in that the slot on the lower bracket can be used for installation or removal.

**Supply includes:**

- 1 set = 4 pc(s).

Material	Packs of	Model No.	Model No.
Zinc-plated	1 set(s)	8018.790	WMSMB
Stainless steel 316L	1 set(s)	8018.791	WMSMB6



### Wall mounting bracket

To mount KL, JB, EB, BG and IT housings based on EL.

**Supply includes:**

- Assembly components for mounting on housing

**Note:**

- For hygiene reasons, and in view of the protection category, the stainless steel housings do not have any drilled holes for the wall mounting brackets

Material	Wall clearance inches (mm)	Packs of	Model No.
Brass, nickel-plated	0.3 (8)	4 pc(s).	1580.000
Carbon steel, zinc-plated	0.3 (8)	4 pc(s).	1590.000
Stainless steel 1.4301 (AISI 304)	0.3 (8)	4 pc(s).	1594.000

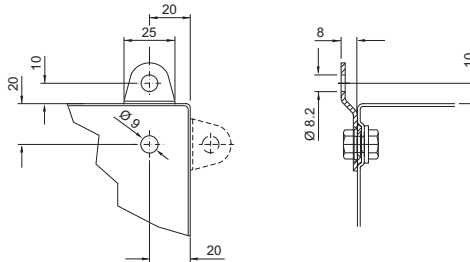

### Wall mounting bracket

for AE, WM

For external mounting on the housing. Simply insert the expandable dowel into the housing hole from the outside, and screw-fasten the wall bracket from the outside.

**Material:**

- Carbon steel

**Surface finish:**

- Zinc-plated

**Supply includes:**

- Wall bracket pre-fitted with seal and expandable dowel

Wall clearance inches (mm)	Packs of	Model No.
0.6 (15)	4 pc(s).	2508.100

